

Garden Highlights, March 2022



Espalier is a way of growing trees and shrubs developed by the ancient Romans, more than 2000 years ago. It is used to grow trees in a small space, grow the plant into a pleasing shape and, in cool climates, position the plant to provide optimum warmth. It requires careful selection of the individual plant, special pruning and tying to prevent the branches from growing upwards. The fruit on espalier trees is very easy to pick - often not requiring a ladder. In some European gardens there are plants, many decades old, growing as espaliers.



What's On in March 2022

Botanic Art, 'Inspired by Nature 7'

Saturday 5 March to Friday 1 April,
Exhibition Gallery, Deakin University,
Western Beach Road, Geelong.
Tuesday - Saturday 10 am to 4 pm.

Design Week Guided walks,

Sunday 20 March:

Wadawurrung Connection 2:00 pm,

The Pacific Rim 3:00 pm.

Bookings: [https://](https://www.geelongcityofdesign.com.au/gdw-event-tickets/)

www.geelongcityofdesign.com.au/gdw-event-tickets/

Discovery Table:

Sunday 20 March 1 - 3 pm.

Above left: The Geelong Gardens is growing espalier apples and pears.

Above right: This vegetable garden near Paris has espalier wires oriented to catch the spring sun.

Free Guided Walks:

Wednesdays 11 am, Sundays 2 pm.

Friends Nursery open:

Wednesdays 9:30 am - 12:30 pm.

The **Conservatory** is open

10 am - 4 pm every day.

The **Tea House** is open every day

(Bookings for groups, etc.

phone 0413 706 535).

Bookings: www.friendsgbg.org.au

Phone: 5222 6053

www.geelongaustralia.com.au/gbg/



Geelong Botanic Gardens map

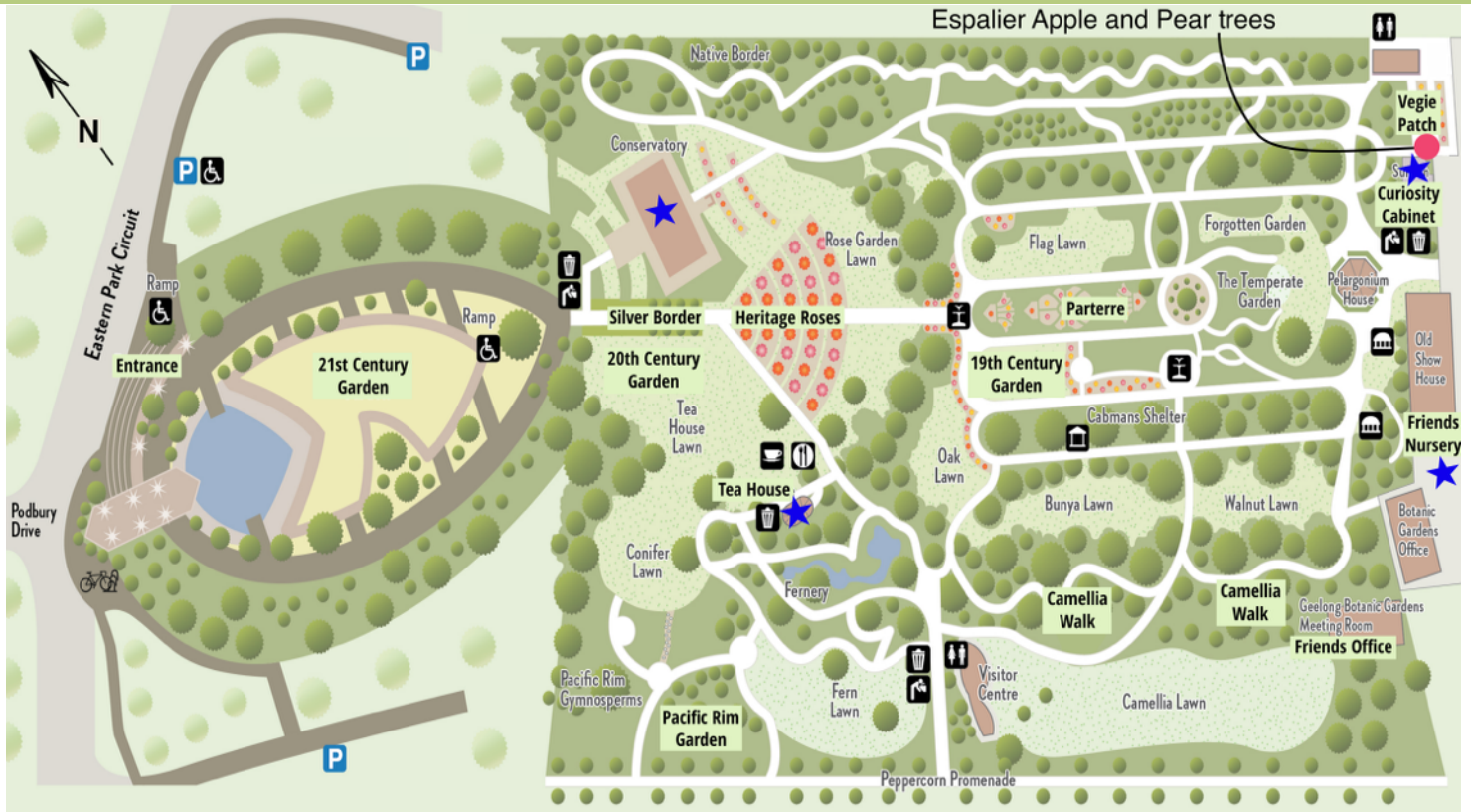

www.friendsgbg.org.au
www.geelongaustralia.com.au/gbg/

This information was developed by the Volunteer Guides
 Friends of Geelong Botanic Gardens.

