

# Garden Highlights, June 2017

These gardens contain many Australian and exotic trees. This month we highlight some of the Australians.

1. The **Bunya Bunya** (Pine) *Araucaria bidwillii* has a distinctive shape with denser foliage at the top. They are native to south east Queensland and 1,000 km north in the wet tropics, but grow well here in Southern Victoria, even out in Eastern Park where there is only rain-water. They produce large seed cones (2 to 18kg) at intervals of 3 to 5 years and all nearby trees synchronise to produce seed in the same year. The seed are large and nutritious. The cockatoos here don't leave a single seed after they have fed.

2. The **Spotted Gum** *Corymbia maculata* has bark that varies throughout the year. Compare the spotted bark in this photo, taken in January, with what you see today. This very tall forest tree grows from near Orbost in Eastern Victoria, along the coast to southern Queensland. The Lemon Scented Gum *Eucalyptus citriodora*, whose leaves have a lemon scent, unlike this tree, grows further north. Between these 2 areas, trees progressively transition from one species to the other. Spotted Gum timber is used for handles of axes and hammers because it copes well with shock.

3. The **Central Australian Palm** *Livistona mariae* only grows wild in a small area in the deep valleys of the Finke River and a tributary, Palm Creek. Its closest relatives are the Mataranka Palm *Livistona rigida* that only occur in the Lawn Hill National Park and the Roper River on the Gulf of Carpentaria, more than 1,000 km from Palm Valley. The Arante people said 'the gods from the high north brought the seeds to this place.' Recent DNA analysis shows these trees came from Roper River between 31,000 and 6,000 year ago. Their ancestors probably brought the trees for their nutritious seed and useful leaves.

4. The **Coastal Tea Tree** *Leptospermum laevigatum* grows along the coast from South Australia to southern Queensland and in northern Tasmania. It copes well with salty air, sandy shores and strong winds, often leaning or lying down in contorted shapes.

**What's on in June 2017** (More details on Friends website)

**Discovery Table**, Sunday 18 June 1:00 - 3:00 pm.

**Discovery Walk**, Sunday 25 June 2:00 pm. Gold coin donation.

**Free Guided Walks**, each Sunday 2:00pm, Wednesday 11:00am.

**The Friends' Nursery** is open on Wednesdays 9:30am - 12:30pm.

See the display in the **Curiosity Cabinet**.

The **Tea House** is open every day.



1.



2.



3.



4.



This information was developed  
by the Volunteer Guides  
Friends of  
Geelong Botanic Gardens

Over page: Map showing plant locations

[www.friendsgbg.org.au](http://www.friendsgbg.org.au)

Phone: 5222 6053

[www.geelongaustralia.com.au/gbg/](http://www.geelongaustralia.com.au/gbg/)

# Geelong Botanic Gardens Map

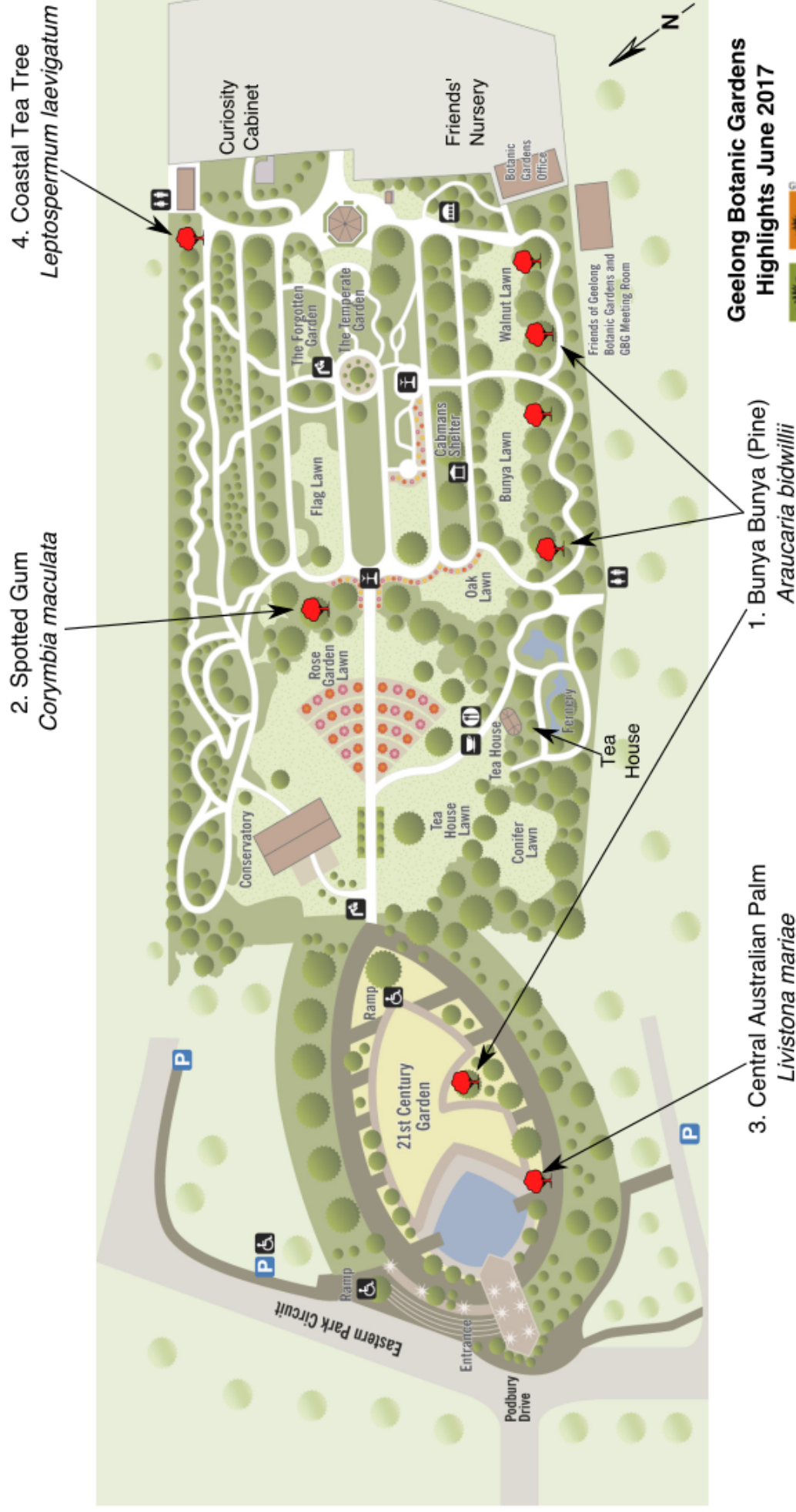

This information was developed by the Volunteer Guides  
Friends of Geelong Botanic Gardens