

Garden Highlights, November 2018

In October and November, two plants have thousands of small flowers. The Grass Tree *Xanthorrhoea malacophylla* has a spike of tiny white flowers, up high above the grassy crest at the top of the tall trunk. This plant was large when it was brought from NSW over a hundred years ago. It is now between 300 and 500 years old.

The Cabbage Tree Palm *Livistona australis* is the only palm native to Victoria. This one has a huge cluster of cream flowers growing at its crown. After the flowers are pollinated they develop into fruit containing a single seed.

What's on in November 2018

Discovery Table: Sundays 4 and 18 November
1:00 - 3:00 pm.

Through the Garden Gates: Monday 5 November.
Book \$30 members, \$40 non-members.

'Roses of love and war', Themed Walk: Sunday
11 November 2:00 pm. Gold coin donation.

'Leave larger than life and blue flowers', Botanic
Art Workshop: Saturday 17 November 9:30 am,
\$90 members, \$100 non-members.

Friends' Christmas drinks and Christmas Fair
opening: Friday 30 November 5:30 to 7:30 pm.
Current members only. Book at office.

Geelong Botanic Gardens: a local treasure:

U3A Course Monday 4 February to Monday 25
March **2019**, 10:00 am 12:00 noon. Book:
www.u3ageelong.org.au, Phone 5244 5114

Free Guided Walks: Wednesday 11:00 am,
Saturday and Sunday 2:00 pm.

Friends Nursery is open:

Wednesdays 9:30 am - 12:30 pm.

See the display of **orchids**
in the Curiosity Cabinet.

The **Tea House** is open every day.

For booking and more details see the Friends
website or phone the Friends office.



Top: Tall Grass Tree *Xanthorrhoea malacophylla* near entrance.
Middle: Another Grass Tree with only a few flowers remaining.
Bottom: Cabbage Tree Palm *Livistona australis* in flower.

Over page: Map showing plant locations

www.friendsgbg.org.au

Phone: 5222 6053

www.geelongaustralia.com.au/gbg/



Geelong Botanic Gardens map

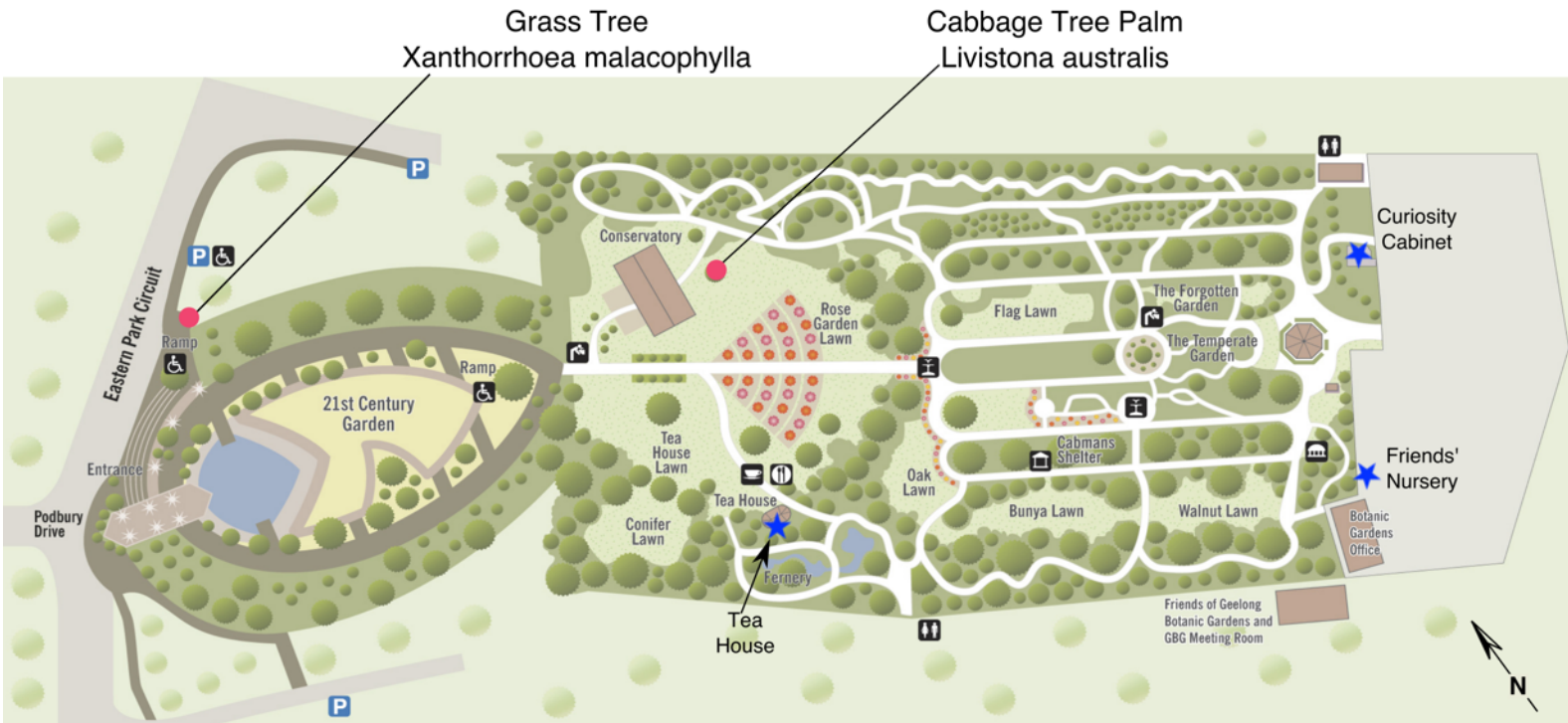

**Geelong Botanic Gardens
Highlights November 2018**