

# Garden Highlights, July 2017

1. You may think that spring and summer are the seasons for flowers, but many plants are not deterred by the winter chill. Visit the Camellia Walk to see Azaleas, Camellias and Gordonia. Camellias and Gordonia are in the family Theaceae that contains the most valuable Camellia of all, the Tea plant. The photo shows ***Camellia japonica* 'Anne Marie Hovey'**.

2. In winter, fern fronds begin to unfurl from a beautiful spiral shape called a crozier. An example is the **Dwarf Tree Fern *Blechnum gibbum*** from New Caledonia and Vanuatu.

3. Aloes are succulent plants from Africa and nearby areas. They cope well with dry conditions. Aloes and many Euphorbias are often mistaken for Cactus plants, but they are in a different family.

4. ***Poinsettia Euphorbia pulcherrima***, is a long night plant. It has a clock that works like an hour glass. It begins the night full of a chemical that leaks away until light returns, when it quickly returns to its full level. However, if the chemical is all gone the plant starts its flowering. Its red and green colours make this plant a favourite for Christmas in the Northern Hemisphere.

5. **Crown of Thorns, *Euphorbia milii* var. *hislopii*** (The label shows its old name, *Euphorbia hislopii*.) *Euphorbia* plants have strange flowers. The small individual flowers that make up the flower head often have no petals or sepals and male and female flowers are separate. Surrounding the flower head there is an array of two or more vividly coloured leaves to attract pollinating insects. The Poinsettia shows this arrangement more clearly than in the Crown of Thorns.

## What's on in July 2017

(More details on Friends or Gardens websites)

**Bug Hotels: School Holiday Program**, various dates 4 - 14 July, 10:00 am - 12:00 pm, \$7.40 per child (Book on GBG website).

Also **free self-guided trail of Bug Hotels**.

**Friends trip to Royal Botanic Gardens**, Melbourne, Friday 7 July.

**How Far can a Mango Go? Discovery Walk**, Sunday 9 July 2:00 pm. Gold coin donation.

**Discovery Table**, Sunday 16 July 1:00 - 3:00 pm.

**Free Guided Walks**, each Sunday 2:00 pm, Wednesday 11:00 am.

The **Friends' Nursery Winter Weekend Plant Sale**, 29 and 30 July 10:00 am - 4:00 pm. The Nursery has new plants in stock.

The **Nursery is also open** on Wednesdays 9:30am - 12:30pm.

See the display of **African Succulents**, in the Curiosity Cabinet.

The **Tea House** is open every day.

Copies now available, of **George Jones' book** 'Growing together: A gardening history of Geelong - extending to Colac and Camperdown'.

Due to building work, the normal office location is not available for the Friends until Monday 17 July. Please contact the Friends by email ([info@friendsgbg.org.au](mailto:info@friendsgbg.org.au)) or call into the Gardens Office to leave a message.



1.



2.



3.

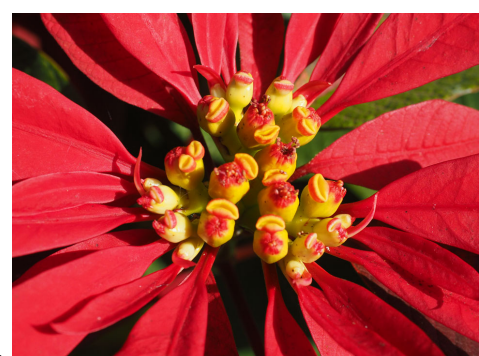

4.

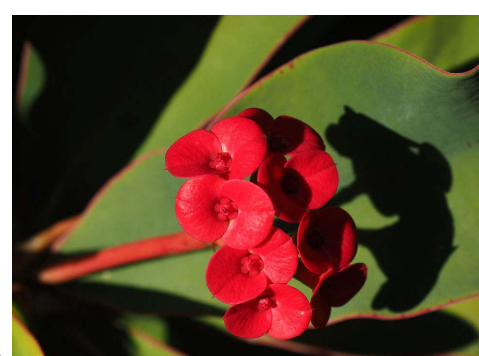

5.



This information was developed  
by the Volunteer Guides  
Friends of  
Geelong Botanic Gardens

Over page: Map showing plant locations

[www.friendsgbg.org.au](http://www.friendsgbg.org.au)  
Phone: 5222 6053  
[www.geelongaustralia.com.au/gbg/](http://www.geelongaustralia.com.au/gbg/)

# Geelong Botanic Gardens Map

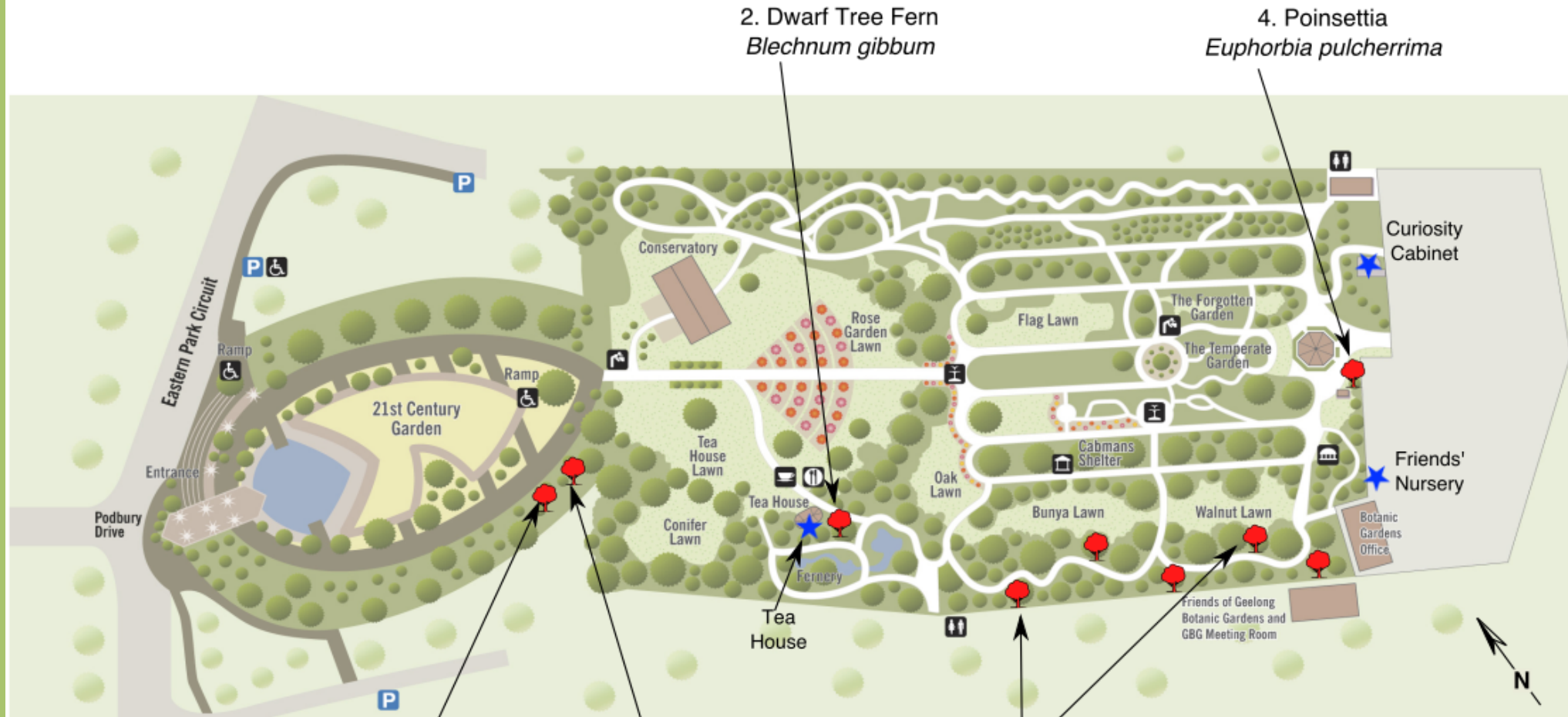

5. Crown of Thorns  
*Euphorbia milii*  
var. *hislopilii*

3. Aloes

1. Camellias  
along Camillia Walk

**Geelong Botanic Gardens  
Highlights July 2017**



[www.friendsgbg.org.au](http://www.friendsgbg.org.au)  
[www.geelongaustralia.com.au/gbg/](http://www.geelongaustralia.com.au/gbg/)

This information was developed by the Volunteer Guides  
Friends of Geelong Botanic Gardens